

RAPTOR E6 Series Quick Start

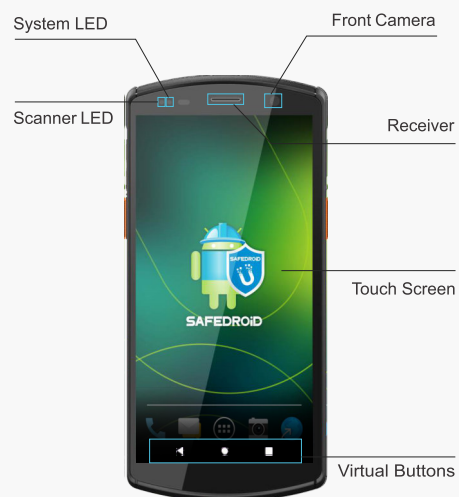

Front view



Side View



Appearance and Buttons



Back View



Package Contents

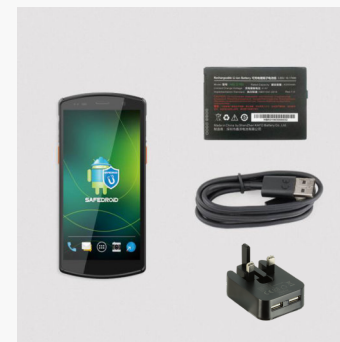

Unpacking Instructions

SIM card, TF card installation method

Use the silver tab on the top left corner to pull out the SIM card/TF card holder. Place the SIM card and TF card into the respective slots (as shown). Push the holder in completely:

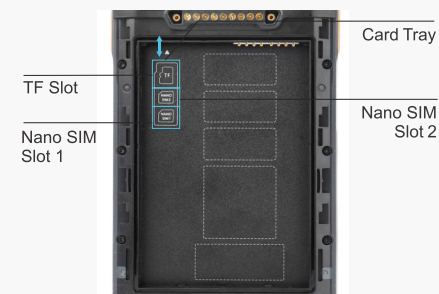

Note: SIM card 1, 2 are Nano SIM cards.

Battery Installation

Install the battery in the orientation as shown. Push the lock buckle to the left (unlock). Place the back cover fully, then, push the lock buckle to the right (lock).



Lock buckle

Power Options

Power on: Press and hold the power button until device vibrates
Shutdown: Press and hold the power button until the shutdown prompt appears Click "Shutdown"
Forced restart: Press and hold the power button for 10 seconds. Do not press the shutdown prompt. Device will restart.

Charging Instructions

USB data cable charging

Connect one end of the USB cable to the adapter, and the other end to the device. Charging cradle is recommended for convenient charging.



USB cable



Power Adapter

PC Connections

Connect device to PC using the USB cable provided.
 If additional driver is required, PC will automatically download from internet.

Once the USB port has been connected, drag the notification bar from the top of the screen to display the USB setting interface (Figure 2).

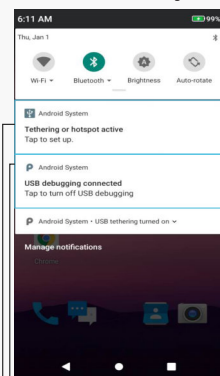

Tap this to activate developer menu shown in Figure 3

Tap this to activate USB preference menu shown in Figure 4

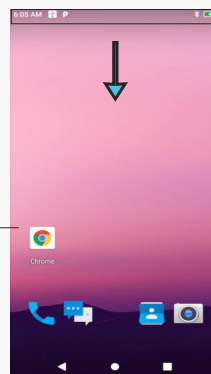

Figure 1

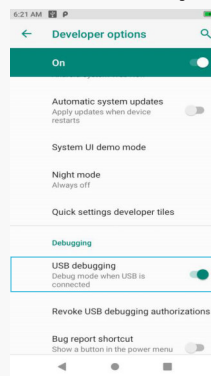

Figure 3

Click this to switch on debug mode

Select this option to access device storage

Select this option to share the device data with the computer.

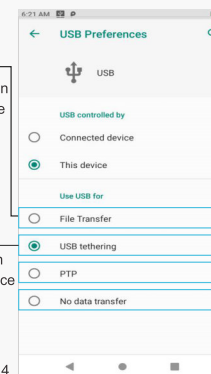

Figure 4

Choose this option to transfer images

Choose this option for charging the device

On Windows PC, go to "My Computer". Click on "Removable Disk" to view and transfer device data.

Note:

- When the DT50 as a SLAVE connect to PC, 'This device' option will be automatically selected.
- When the DT50 as a HOST connect to other devices, 'Connected device' will be automatically selected.

Indicator

Battery		Full power
		Medium power
		Charging
Network signal		Low power
		Good signal
		Unstable signal
WiFi	NONE	SIM card not installed
		SIM card error/no service
		WiFi on. No available wireless networks for connection
NFC		WiFi connected
	NONE	WiFi switched off
		NFC switched on

Precautions

- Read all information in this guide before using the device to ensure safe and proper operation.
- Please use the accessories that have been approved by this manufacturer and corresponds to this model. Use of any power source, charger, battery, etc. that has not been approved by this manufacturer may cause a fire, explosion, or other hazards.
- Please use device and accessories within the specified temperature range. Equipment failure may occur when the ambient temperature is too high or too low.
- Do not disassemble the product and its accessories. If the equipment or any of its components are not working properly, consult the after-sales service of the company promptly, or send the equipment to the after-sales service outlet for testing and maintenance.
- The battery is made from a flammable and explosive material. Do not disassemble, squeeze, drop and make any other destructive operations on the battery. Do not place the battery in high temperatures.
- Disposal of used batteries is subject to local relevant documents or policies regarding disposal of used batteries.

Warranty Policy

Thank you for using intelligent terminal series products. In the situation of quality problems, which arise from raw materials or production processes, during normal use of purchased products, Raptor hub UK Ltd will be responsible for free maintenance within one year from the date of purchase. The company may provide repairs due to the user's failure to use the product according to the provided instructions of the product. However, corresponding service fee and component fee will be charged.

Warranty regulations:

- Under normal circumstances, the warranty period of the device is 12 months (3 months for accessories), subject to the sales agreement.
- During the product warranty period, under the normal use conditions (determined by our technical staff), the user will be entitled to a free warranty for damaged or faulty warranty parts.
- During the warranty period, faults caused by repair, disassembly or modification of the product by a personnel other than our company, improper installation, improper use by the user (failure to follow instructions), serial number damage, accident or natural disaster, will not be covered under the warranty.
- The warranty will expire immediately if any alterations are made to the warranty
- Please show the equipment SN and purchase certificate for repair. The company reserves the right to interpret the above contents.